



StealthLock™ Installation Guide

HOW MANY CLIPS DO YOU NEED FOR YOUR DECK?

JOIST SPACING (ON CENTER)	NUMBER OF CLIPS NEEDED		
	50 SQ. FT.	100 SQ. FT.	200 SQ. FT.
12 in.	117	233	466
16 in.	90	180	360

TOOLS NEEDED

Required

Drill - We recommend an 18v or greater cordless driver drill with adjustable clutch setting

Recommended

CAMO ClipDRIVE™ - attaches to your drill for stand-up clip fastening

CAMO LEVER® - locks in rows of boards and clips

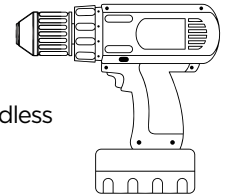

Pro Tips for the Best Deck Install Experience

- Always review and follow your deck board manufacturer's gap spacing and on-center span requirements for deck board installation.
- Use proper personal protective equipment for every job.
- Before installing deck boards on wood framing, apply Deckorators Deck Tape to top of joists, rim joists, ledger boards, deck blocking, and under joist hangers. Deck Tape creates a waterproof membrane to protect the deck framing from moisture and rot.
- You may use CAMO starter clips to start your decking project.



LEARN MORE ABOUT CAMO STARTER CLIPS



- Double (sister) joists are required at all butt joints to accommodate one clip on each joist. See BUTT JOINT instructions on page 3.



- You must have unobstructed airflow under 50% of the deck to allow for sufficient cross-ventilation from one side to the other.
- Unless you are using the Deckorators Surestone sleeper system and Surestone decking, your deck should **not** be installed directly over any solid surface such as concrete.

Installation Guidelines for Specific Deck Board Materials

Grooved Deckorators® Surestone™ Technology Deck Boards

Please refer to the Decking Installation Instructions on Deckorators.com for proper end gapping, joist spacing and installation requirements.

<https://www.deckorators.com/pages/installation-instructions>



- Two fasteners per joist minimum.
- Ends of each board must fall on a joist. 1" maximum cantilever.
- Install the entire deck at same temperature.
- Install the deck boards starting from the outside edge of the platform and work toward anchor wall so that ripped pieces abut the wall. Start installing from one end of the board and work toward the other end of the board.
- Start installing from the center of the board and work out toward the ends of the board. Do not install by fastening each end first and working toward the middle. To keep the interior boards from moving over time, we recommend pinning the boards at the center of their

length using a #8, 2" stainless steel screw. This holds the deck board in place at the center of each board and allows the decking to expand/contract at the ends. Pre-drill in the groove of the deck board with an 1/8" drill bit. Drive screw into the groove so it's flush with the bottom of the groove. This will allow you to properly fit a hidden fastener into the groove.

- Fastener slots may be routed into the side of the solid, non-grooved deck boards, as needed.

Gapping requirements

Surestone Technology Boards

	Above 32° F (0° C)	Below 32° F (0° C)
Side-to-Side	1/8"	3/16"
End-to-End	1/16"	1/8"
End-to-Side	1/16"	1/8"
Abutting Solid Objects	1/8"	1/4"

- Allow 1/4" distance between all decking material and permanent structures or posts.

Installation Guidelines for Specific Deck Board Materials

Grooved Hardwood Deck Boards

- Boards should acclimate on-site for at least 7 days before installation.
- Use the sticker method while acclimating to allow proper airflow.

Hardwood decking has a maximum overhang of one inch on the end of the board and should be supported if overhanging more than 1/4" along the edge of the board.

Grooved PVC Deck Boards

- Because of the potential for linear expansion and contraction from temperature variance, use shorter board lengths where possible.
- Use a breaker board design to shorten board runs.
- Follow manufacturer's installation instructions for proper board end to end gapping and end to side board spacing.
- For board runs 16' and longer, face fasten at the midpoint and at both ends of the boards with Deckorators color matched stainless steel composite screws. (plug systems are acceptable)
- Boards should be kept at ambient temperature and shaded from direct sun prior to cutting and immediate fastening

Before You Begin Drill Setup for StealthLock™

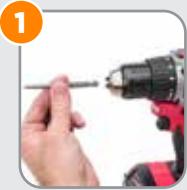

1 Insert the included T-15 driver bit into your drill. Do not use an impact driver.

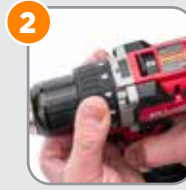

2 If your drill has a drill and clutch mode, set it to clutch mode. Turn down torque to the lowest setting. Increase as necessary

StealthLock™



For use with wood joists

LEARN MORE ABOUT STEALTHLOCK:



1 Tilt the StealthLock Clip so the lower prongs enter the groove first. Tilt the clip back up to wedge into the groove. Clips stay in place until you're ready to fasten.



2 Install a clip at every joist along the length of the board.



3 Slide the next board up against the clips, and repeat until you have multiple rows of boards and clips.

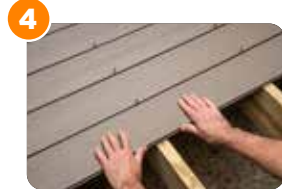

4 Hold the boards tightly, or lock them in place with CAMO LEVER® (sold separately).



5 Starting at the outermost board, place the NEVER-MISS® Guide (included in 450 and 900 CT. pails) over the screw head. Connect the bit to the head and drive until the clip is snug. **Do not overdrive.** Repeat until all inner boards are fastened.

OPTIONAL INSTALLATION METHOD

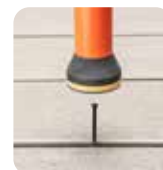

To fasten with ClipDRIVE - starting at the outermost board, put the nose over the screw head and drive at full RPM while applying downward pressure. Repeat until all inner boards are fastened.

SPECIAL CASES

BUTT-JOINTS

ALWAYS INSTALL A DOUBLE JOIST AT THE BUTT JOINTS.

Use a separate clip to secure each board end. Please follow your deck board manufacturer's instructions for end-to-end board gapping distance to allow for expansion and contraction at this joint.

4 CLIPS
ARE NEEDED
FOR EACH
BUTT JOINT.



1



Place 4 clips centered on joist on both sides of the boards.

2



Place the next board up against the clips then fasten the screws.

REPLACING DECK BOARDS

1



Back out all of the screws from the joist on both sides of the board.

2



Pull up on the board to easily remove it.

3



Clean away any clips remaining on the joists and lay the new deck board in position without any clips in place.

4



Count the number of clips needed and snap off the prongs on each StealthLock clip.

5



Slide the clips (screws and gussets) down the groove, positioning one over each joist on both sides of the board.

6



Fasten clips securely in place using the NEVER-MISS® Guide.

ADDITIONAL CAMO TOOLS ARE AVAILABLE TO HELP YOU BUILD BETTER

CAMO **CLIPDRIVE™**

STAND UP FASTENING TOOL FOR CAMO® UNIVERSAL DECK CLIPS

- Install grooved decking up to 5X faster
- For use with CAMO Universal Deck Clips on leading grooved deck boards
- Attaches to your drill, features an adjustable handle, and has a weighted nose for easy screw targeting
- Ergonomically designed to be easy on the body and reduce fatigue on the job
- CAMO Universal Deck Clips and the ClipDRIVE are backed by a CAMO Warranty



CAMO **LEVER®**

BOARD BENDING AND LOCKING TOOL

- Speeds up grooved deck installs—locks-in rows of boards and clips before fastening
- Strong enough to straighten any warped board
- Easily adjusts to wood and metal joists 1-1/2–3 in. wide for jobsite versatility
- Multi-directional lever locks in one turn



Check out all the ways that other CAMO branded tools and materials can help you build better.

**FOR MORE
INFORMATION**

